



TAPING SPECIFICATIONS

ORIENTATION OF POLARITY: All polarized capacitors must be oriented in the same direction.

INTERRUPTION OF SEQUENCE: No consecutive capacitors may be absent. Empty spaces <0.1% of reel quantity.

SPLICES: Splice tape strength must be equal to Non-splice tape.

Splice thickness: ≤4 single tape layers

Splice offset: <0.3 mm

REFERENCE STANDARD: EIA RS 468A

Formed lead Taping

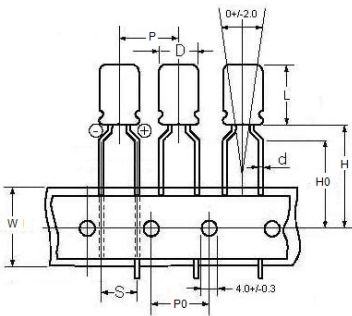

Straight lead Taping

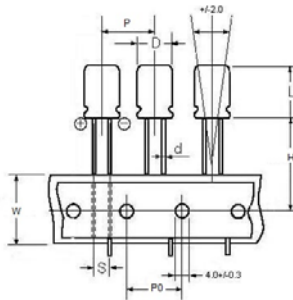

SQ Taping

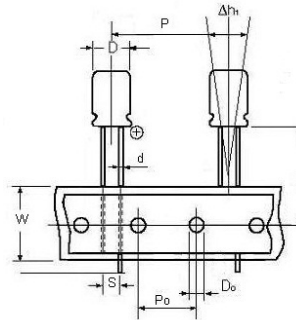

SH Taping

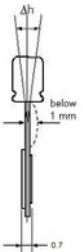
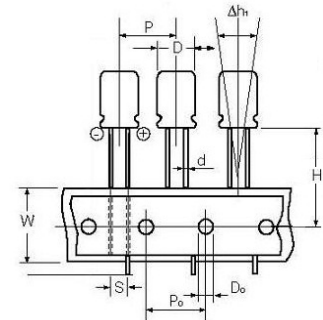

	Formed lead spacing				Straight lead spacing									Tol.
	4.0	5.0	6.3	8.0	4.0	5.0	6.3	8.0	10.0	12.5	16.0/ 18.0	12.5		
Lead spacing (S)	5.0				1.5/2.5	2.0/2.5	2.5	3.5	5.0	5.0	7.5	5.0	+0.8/-0.2	
Taping code	SA				ST1/ ST	ST2/ ST	ST	SF	SA	SA	SQ	SH		
Capacitor Pitch (P)	12.7				12.7					25.4	30.0	15.0	±1.0	
Feed hole pitch (P0)	12.7				12.7					12.7	15.0	15.0	±0.3	
Feed hole to first lead (P1)	3.85				5.1				3.85	3.85	3.75		±0.7	
Carrier width (W)	18.0				18.0					18.0			±0.5	
Feed hole position (W1)	9.0				9.0					9.0			±0.5	
Height of seating plane (H)	17.5	18.5	18.5	20.0	18.5					18.5	16.0	±0.75		
Lead wire clinch Height (H0)	16.0				----					----			±0.5	
Feed Hole Diameter (D0)	4.0				4.0					4.0			±0.3	
Front to Back inclination (Δh)	0.0				0.0					0.0			±2.0	
Body inclination (Δh1)	0.0				0.0					0.0			±2.0	
Tape thickness (t)	0.7				0.7					0.7			±0.2	

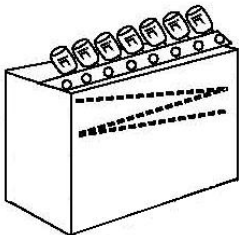

Box Dimensions (mm)				
D	L	H	T	
≤6.3	325	229	51	
8.0	330	240	51	
10.0	330	191	51	
12.5	325	267	58	
16.0	315	221	63	
18.0	343	275	63	

For D≤8mm and Capacitor length ≤7mm box thickness is 45mm.

Box Quantity				
Diameter	4.0	5.0	6.3	8.0
Quantity	2500	2000	1500	1000
Diameter	10.0	12.5	16.0	18.0
Quantity	500	450	250	250