



### FEATURES

High Voltage – Very Fast Charge/Discharge – High Power Density – RoHS Compliant

### APPLICATIONS

Solar/Wind Energy Storage – Pulse Power – Energy Harvesting – UPS Systems – Smart Electric Meters

<b>Operating Temperature Range</b>		<b>-15°C to +70°C</b>	
<b>Storage Temperature</b>		<b>-40°C to +70°C</b>	
<b>Capacitance Tolerance @ 20°C</b>		<b>+20% / -20%</b>	
<b>Surge Voltage</b>	<b>WVDC</b>	<b>3.8</b>	
	<b>SVDC</b>	<b>4.2</b>	
<b>Life Time</b>	<b>1000 hours with rated voltage applied at 70°C</b>		
	<b>Capacitance change</b>	±50% of initially measured values	
	<b>ESR</b>	<1000% of initially specified values	
	<b>Leakage current</b>	≤100% specified maximum value	
<b>Shelf Life</b>	<b>1000 hours with no voltage applied at 70°C</b>		
	<b>Capacitance change</b>	±30% of initially measured values	
	<b>ESR</b>	<200% of initially specified values	
<b>Life Cycles</b> (25°C) 1 cycle = Charge / Discharge from 3.8~2.5VDC	<b>500,000 cycles</b>		
	<b>Capacitance change</b>	±30% of initially measured values	
	<b>ESR change</b>	<200% of initially specified values	

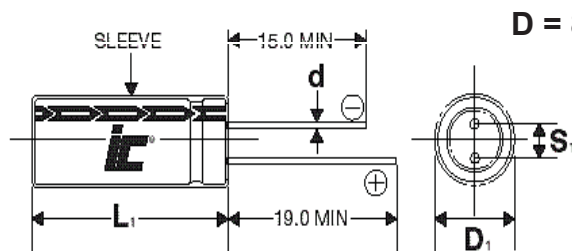

**D = 8 to 18mm**

Lead spacing VS. Case diameter					
D	8	10	12.5	16	18
S	3.5	5.0	5.0	7.5	7.5
d	0.6	0.6	0.6	0.8	0.8
α	1.5	2.0	2.0	2.0	2.0

$L_1 = L + \alpha$  mm  
 $D_1 = D + 0.5$  mm  
 $S_1 = S \pm 0.5$  mm